

Changing a Symmetry Bag

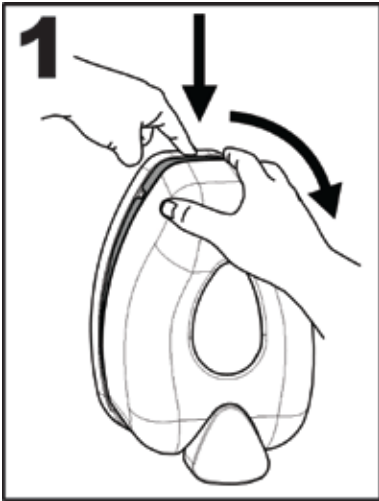

Depress top of wall bracket to disengage lock while opening the front cover

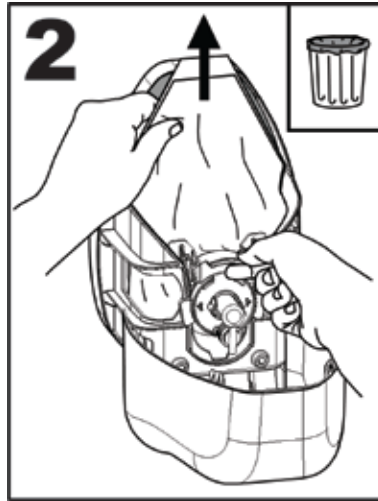

Remove empty Symmetry bag and dispose in proper receptacle

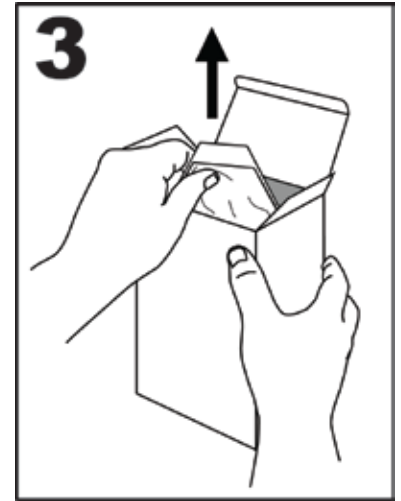

Remove new Symmetry bag from inner carton

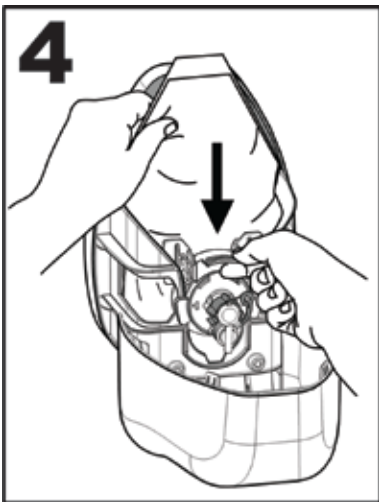

Insert the new Symmetry bag ensuring that the gray ring is completely seated in the dispenser

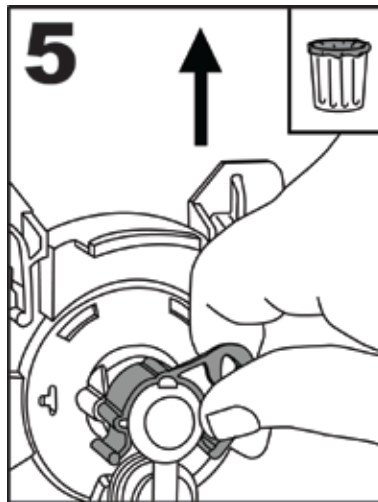

Remove red shipping tab

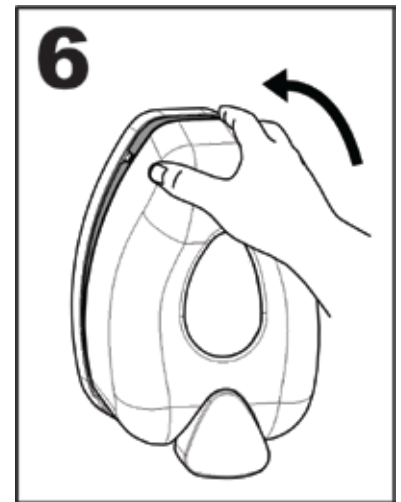

Close dispenser